



**Cogan**  
Since 1901



**Partitions**  
24/7 Security

cogan.com

## ORIGINAL (STRUCTURAL ANGLE) WIRE MESH PARTITION

### PANELS

#### Description

Panels are made of 2" x 2" x 10 GA welded wire mesh framed in 1 1/4" x 1 1/4" x 12GA structural angle with one or two welded 1/2"  $\varnothing$  reinforcement rods.

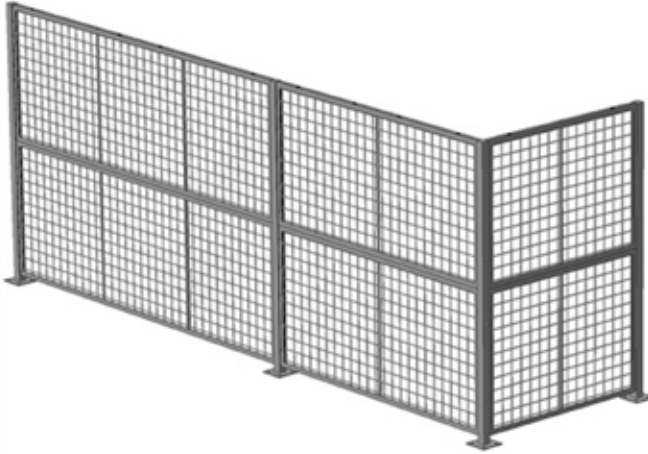

### PRODUCT INFORMATION

Panels are made of 2" x 2" x 10 GA welded wire mesh framed in 1 1/4" x 1 1/4" x 12 GA structural angle with one or two welded 1/2"  $\varnothing$  reinforcement rods.

#### SPECIFICATIONS

|                    |   |
|--------------------|---|
| Panel Heights      | 1' to 5'                                |
| Panel Width        | = (C/C Post Spacing) - 2"               |
| Finish             | Powder-coated                           |
| Mesh Size          | 2" x 2" x 10GA                          |
| Material Mesh      | Steel Wire                              |
| Frame Material     | Structural Angle 1 1/4" x 1 1/4" x 12GA |
| Stiffening Profile | 1/2" $\varnothing$ Reinforcement rod    |

#### COLORS



Cogan Grey



**Cogan**  
Since 1901



**Partitions**  
24/7 Security

cogan.com

**ORIGINAL (STRUCTURAL ANGLE)  
WIRE MESH PARTITION**

## DETAILS

Panels are made of 2" x 2" x 10GA welded wire mesh framed in 1 1/4" x 1 1/4" x 12GA structural angle with two welded  $\varnothing 1/2"$  reinforcement rods.

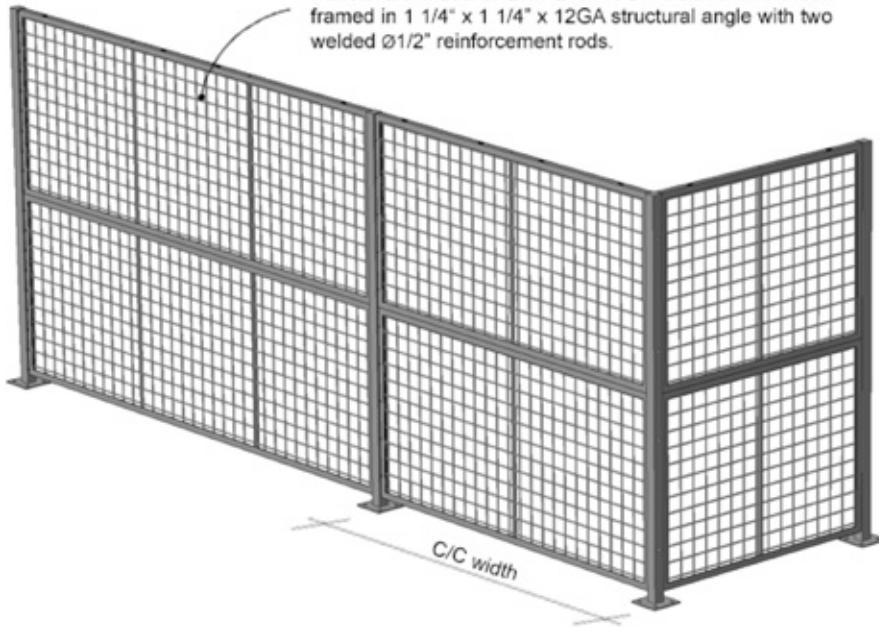

Panel dimensions are based on center-to-center post spacing. To calculate exact panel width apply the following:

$$\text{Exact panel width} = (\text{C/C dimension}) - 2"$$



## LAYOUT OPTIONS

Offering the finest support in the industry, our skilled engineers can help you configure your partition any way you want, building alongside existing structures or creating an enclosed room.

Please choose from one of the options below.

**OPTION 1**  
1-SIDED LAYOUT PARTITION



**OPTION 2**  
2-SIDED LAYOUT PARTITION

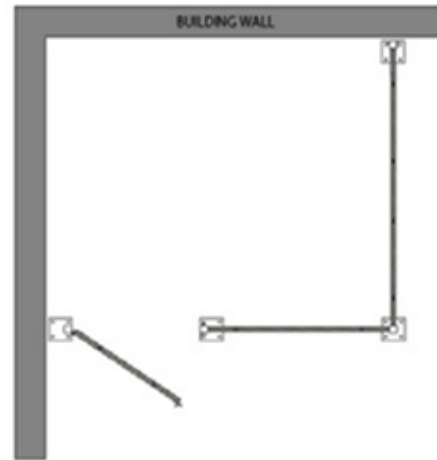

**OPTION 3**  
3-SIDED LAYOUT PARTITION

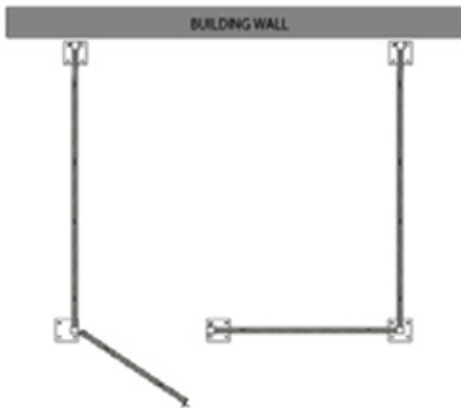

**OPTION 4**  
4-SIDED LAYOUT PARTITION

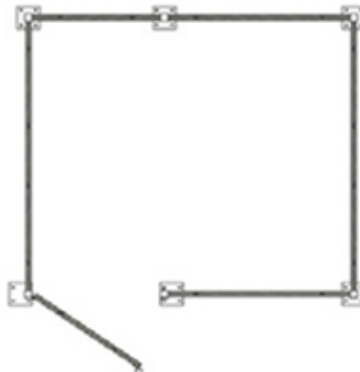

**OPTION 5**  
CUSTOM LAYOUT PARTITION

